

7.Precautions

- 1.The fixture must be installed by a qualified professional.
- 2.Installation must be done with the power off to prevent electric shock or equipment damage.
- 3.Do not disassemble or modify the fixture yourself, as this may reduce its safety protection level.
- 4.Install the fixture away from heat and vibration sources to avoid operational interference.
- 5.Ensure the power lines (neutral, live, and ground wires) are correctly connected and securely fastened.
- 6.Wiring Instructions: When connecting to the power supply, use a junction box with an IP rating that is not lower than the fixture’s IP rating. The wires should be connected inside the terminal, with proper wire fixation in place.
- 7.Ensure the product’s specifications match the local electrical grid parameters.
- 8.Avoid contact with corrosive chemicals, as they may damage the fixture.
- 9.Before installation, check the technical data and specifications on the nameplate to ensure they match actual use conditions. Ensure all components are intact before connecting the power.
- 10.Do not dismantle the fixture without proper authorization. Disconnect the power supply before performing any maintenance or inspection.
- 11.During maintenance, avoid damaging explosion-proof surfaces. After servicing, apply anti-rust oil, and securely close the fixture before use.

INDLEDs(Shenzhen) Co.,Ltd

Add: 402Workshop, B3 Lift, B building, Jinkaijin Industry Park, Shiyan town, Bao'an District, Shenzhen , China

Tel: 0755-23078774

Email: [eric@indleds.com](mailto:eric@indleds.com)

Website: [www.indled.com](http://www.indled.com)

1.Product Description

The Line9 is suitable for dual workstations with a desktop length of 0.9-1.2 meters.  
The Line12 is suitable for dual workstations with a desktop length of 1.2-1.6 meters.  
The Line24 is suitable for dual workstations with a desktop length of 2.4-3.2 meters

2.Specification

Name	Line9/Line12/Line24
Model No	ZLE09/ZLE12/ZLE24
Input Voltage	100-240V ~ 50Hz
Consumption	□60W □85W □170W □14×3.2W/14×1.5W □20×3.2W/20×1.5W □40×3.2W/40×1.5W
Luminous	□2300Lm/5850Lm □3286Lm/8320Lm □6572Lm/16640Lm
Efficacy	≥130Lm/W
Color temperature	4000K
CRI	≥93
Operation temperature	-30℃ ~ 40℃
Protection	IP54
Size	□906×420×1950 □1206×420×1950 □2406×420×1150
Weight	□8kg □9kg □7kg

### 3.Product component

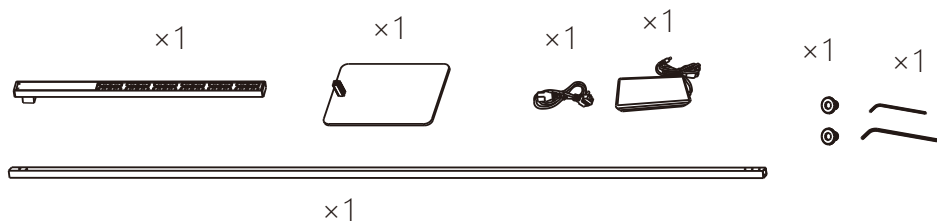

### 4. Installation

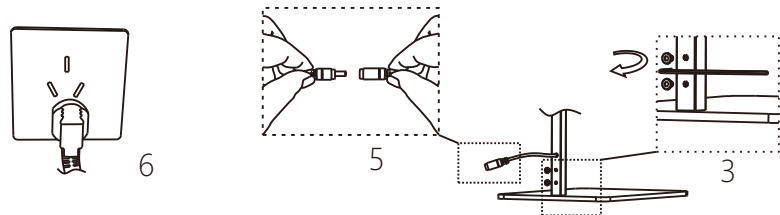
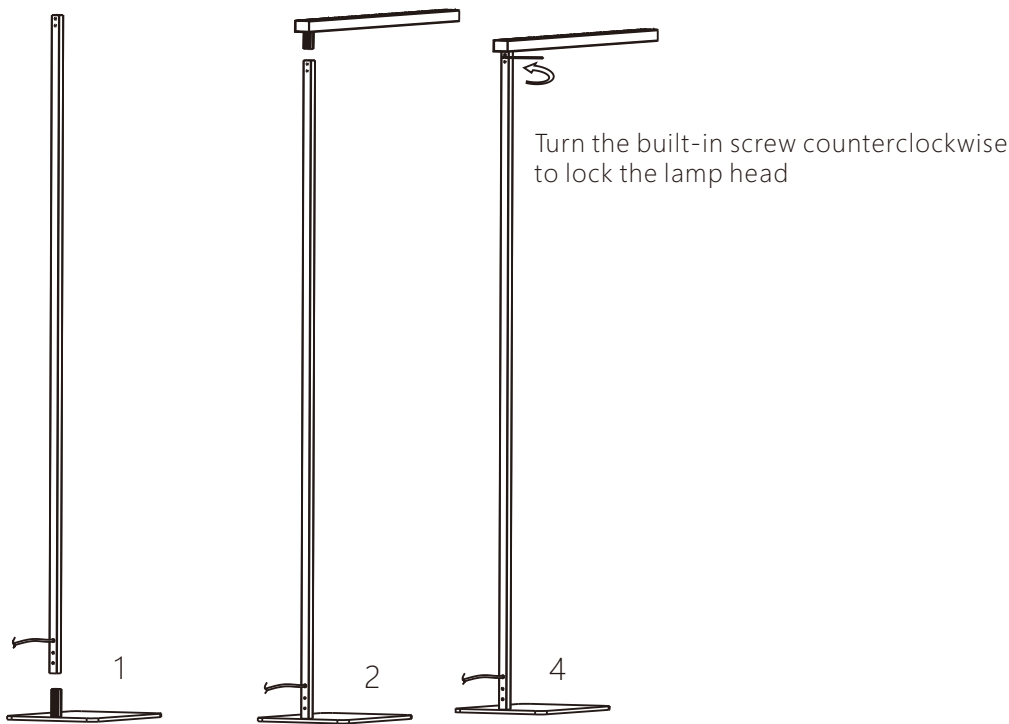

### 5.Instruction

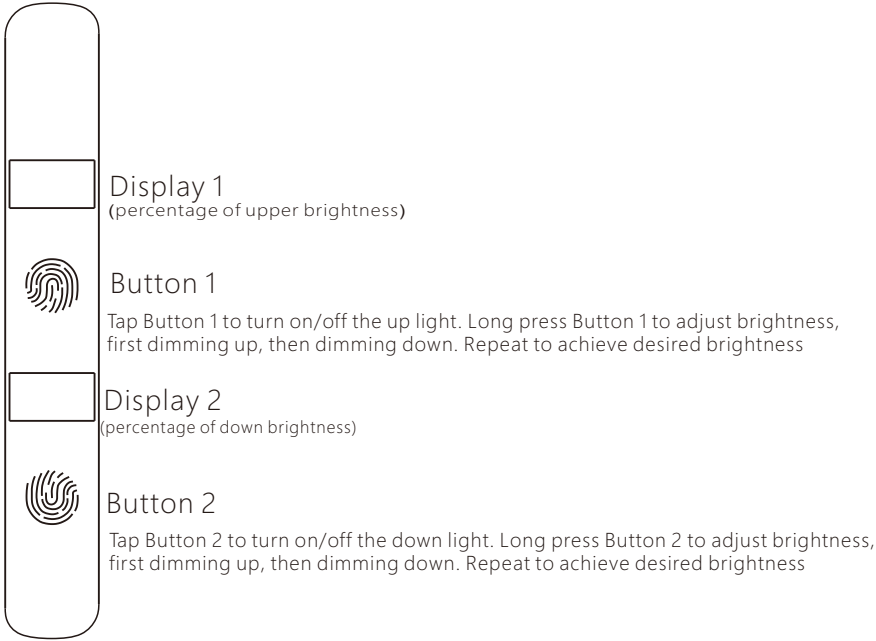

- Manual mode: Tap button to turn on/off the lamp
- Human sense mode: When the light is sensed, the human body will be on, and the light will be automatically extinguished after the person walks for 5 minutes. The human return sensor will automatically light up when it detects the human.
- Mode switch: Turn on the lamp, press and hold button 1 and button 2 at the same time, after 3 seconds, the lamp will flash twice to start the human sense mode. Same operation, the lamp will flash once to start the manual mode.

**Warning:** The lamp will not automatically turn on or off after being manually turned off in the human sense mode.

### 6.Warranty

The lamp body is covered by a 5-year warranty from date of purchase.