

veain



# veain AirLits5 Pro True Wireless Earbuds

## User Manual



## Pairing connection

1

### Power on

Open the box cover, the earbuds will automatically turn on. And the colorful light of charging box will stay on for 20s, then the orange & white breathing light starts to work.

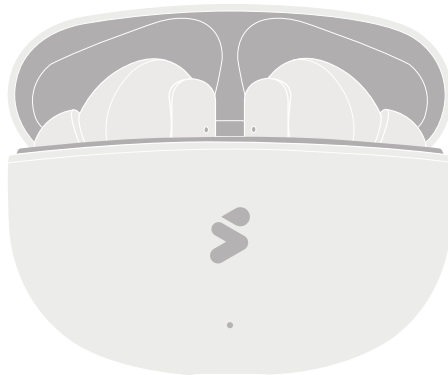

## 2 Pairing mode

For the first time using, the earbuds will automatically enter the pairing state after power on

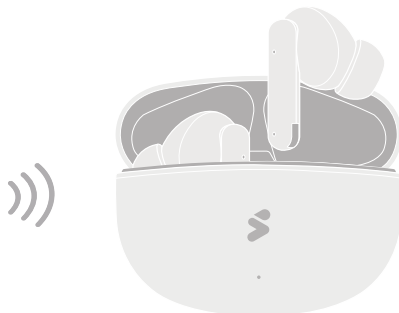
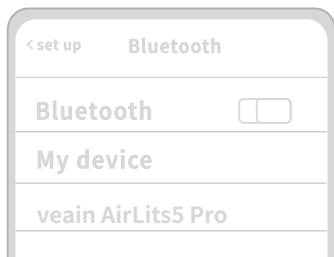

## 3 Wireless connectivity

Turn on the Bluetooth of the pairing device, search the device named “veain AirLits5 Pro”, and connect.

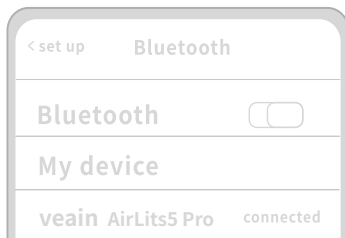

## 4

## Power off

Put the earbuds back to the charging case and close the lid, then earbuds will automatically turn off.

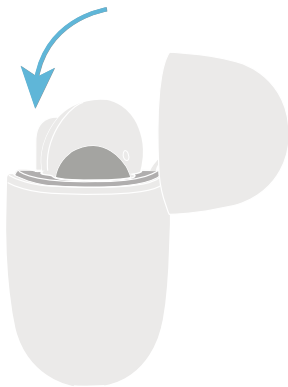

## Note

In pairing mode, if the connection is not done within 10 minutes, the earbuds will automatically turn off.

The earbuds will record the device information, and will automatically connect with the device next time.

## Music mode

- • ▶ Double click left and right earbud(L or R) : Play/pause
- • • ⏮ Triple tap left earbud(L):Last song
- • • ▶ Triple tap right earbud(R):Next song
- 🔊 Click left earbud(L) : decrease volume
- 🔊 Click right earbud(R) : increase volume
- 🗣 Long press for 2S on left or right earbud (L or R) :Voice Assistant

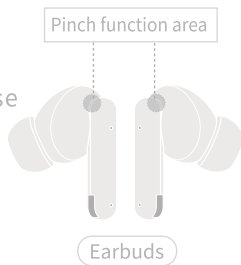

## Call mode

- • 📞 Double click left or right earbud (L or R) : Answer/Hang up
- • ⏹ Double click left and right earbud (L or R) : Cancel dialing
- 📞 Long press for 2S on left or right earbud (L or R) :Reject a call

## Turn on/off manually

- ▶ Power off state Long press for 3S left or right earbud (L or R) : Turn on
- 🔌 Long press for 5S left or right earbud (L or R) : Turn off

## Low Latency Mode

Click 4 times continuously on left or right earbud (L or R) : Turn on/ off

## Factory data reset

When the earbud is on and without connecting any device , click the left and right earbud 6 times in the same time. After 4 times warning beeps, the earbuds will restore factory setting and shut down.

Note: After restored factory setting, you have to delete the original link name on the paired device and reconnect the Bluetooth.

## Earbuds charging

Put the earbuds back into the charging case and closed the lid, now the earbuds are ready for charging.

When the earbuds are in charging status, the orange breathing lamp will turn on, and will turn off till fully charged.

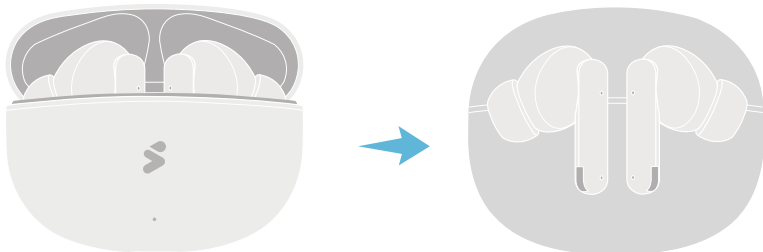

## Case charging

The orange light will blink slowly when charging, and the orange light will stay bright after fully charged.

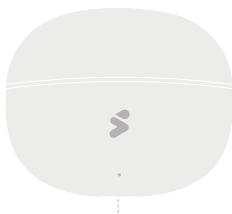

Take out the earbuds, then put it in the charging case, display the power information:

White light blinking  
White lights on

Power 0-5%  
Power 5-100%

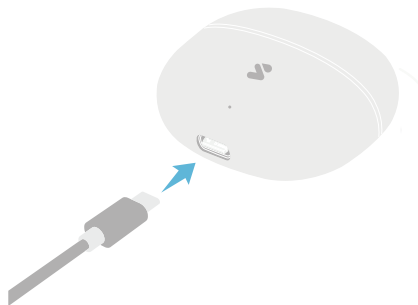

## Product safety information

Please read all instructions and warnings before using this product. Improper use will damage the product or create safety issue.

- To prevent possible hearing damage, do not use a high volume for a long time.
- Keep the device and accessories away from children and pets. Swallowing it may cause suffocation and other serious consequences.
- The battery is built inside of the product, please do not expose it under strong sunlight, keep it from fire or overheating resource; If water get inside of the device, dry it naturally before using.
- To avoid electromagnetic interference, keep the device at least 15 cm away from the implantable medical devices or personal medical devices (such as pacemakers, cochlear implants, hearing AIDS, etc.) and consult the device manufacturer for constraints.
- Company shall not be liable and bear any legal liability for any personal and property loss due to improper use against the warning in the user manual.
- Disassembly of the product by non-professionals is strictly prohibited.
- Overvoltage and Overcurrent in exceed of the rated power shall be avoided
- Intense physical acting force including hitting, throwing, trampling , violent squeezing etc. shall be avoided.
- The suggested ambient temperature of the product is 0-35°C, and the suggested storage temperature is -20 °-45°C. Too high or too low ambient temperature may lead to malfunction.

# FAQs

## **1. Why my product can't be turned off?**

A: ① Make sure that the earbuds was put back into the charging case, and cover the lid, the earbuds will be switched off automatically;  
② When the charging case is out of power, please turn off the Bluetooth on your device, the earbuds will be switched off automatically in 10 minutes;  
③ Keep earbuds and charging case clean, and regularly clean them with dry cloth (Too much Dirt will lead to poor connect, Earbuds connect with charging case with some kind of metal pins).

## **2. Why the touch control malfunction?**

A: ① Make sure there is no water or other materials covered on the touching panel of earbuds.;  
② Make sure that you are clicking the touching panel, and complete double-click within 0.5s.

## **3. Why the earbuds can' t reconnect with my device?**

A: ① The earbuds will be disconnected beyond 10 meters effective range. And will switch off if keep disconnected over 10 minutes;  
② Put the earbuds back into the charging case and cover the lid, and take out it again, it will reconnect with your device.

## **4. Why one of the earbuds is not working?**

A: ① If this problem occurs, please put the earbuds back into the charging case, close the lid, and take the earbuds out again;



- ② If the problem still exists, please clean the charging case and earbuds and try again(probably poor contact due to dirt)
- ③ If above 2 measures don't work, please turn off Bluetooth, restore the factory setting, and reconnect your device.

### **5. How to keep earbuds in best sound quality status?**

- A: ① Play music at one-third of normal volume for 12 hours (softer music);
- ② Play music at two-thirds of normal volume for 12 hours (any music except strong rock music);
  - ③ Play music at normal volume for 72 hours (normal music);
  - ④ Play music at three-fourths of normal volume for 24 hours (normal music).

### **6.The wireless earbuds cannot be found in Bluetooth page/Unstable connection/Disconnection during use/Sound lagging**

- A: ① Keep earbuds within 10 meter effective range, avoid blocking of wall;
- ② Make sure the earbuds have enough power, and enter pairing mode, reconnect with the device;
  - ③ If above measures did not work, please turn off the Bluetooth and restore factory setting, reconnect again;
  - ④ Due to the property of the earbuds, there might be electromagnetic interference to your earbuds in certain area, resulted in sound lagging or disconnection (subway WIFI traffic lights, etc.). Please stay away from electromagnetic radiation source and reconnect again .

The charging data is obtained from test reports provided by the SHKOD laboratory. The actual charging time may vary depending on the operating conditions or individual difference

# Product Parameter

## Product Name: veain AirLits5 Pro True Wireless Earbuds

Product model: AirLits5 Pro	Input: DC 5V = 70mA fast charge
Material: ABS	Charging case input: DC5V = 1A
Bluetooth version: V6.0	Charging time: 1.5h
Noise reduction: Four built-in ENC	Frequency response range: 20Hz -- 20KHz
Active noise cancellation:36dB	Charging interface: Type-C
Communication distance: 10m	Product weight: 39.6g
Standby time: about 450h	Earbud battery: 40mAh/ 3.7V
Playing time: about 8 h volume (60%)	Charging case battery: 350 mAh / 3.7V
Total playback time: 40 ~ 45h	Connect time: 40ms low delay
Product size: 5.89*4.88*2.42 (cm)	

# Product Parameter



charging case  
x1pcs



Earbuds(L&R)  
x1pcs



Ear cup  
x4pcs



Warranty card  
x1pcs

Brand Name: SHKOD

Company Name: INVEA Electronics Private Limited

Contact Address:Office No 3A, 3rd Floor A-1 Sector-10, Noida, Gautam Buddha Nagar, Uttar Pradesh-201301

Customer Care Contact: 1800-257-9808



Warning please follow the above safety instructions otherwise it will failure, electric shock, damage or other damage

Power by SHKOD  
Made in PRC