



Easily upgrade to LED from fluorescent.

TOPSTAR Ballast Compatible LED HO/HE T5 Lamps are an ideal energy saving choice for existing linear fluorescent fixtures.

Perfect for a wide range of applications

- Full light output in spaces with temperatures down to -4°F (-20°C)
- Perfect for applications with frequent “on/off” switching cycles
- Buildings that desire to be mercury free

Easy to experience

- Instant on, no flicker or buzz
- Fits into existing linear fixtures
- Optimized performance with Electronic Ballasts
- Eliminates the need for rewiring and allows the fixture to maintain original UL and CSA compliance
- CRI 80
- Power Factor > 0.9
- THD < 20%

Easy to experience

- No mercury allowing for non-hazardous waste disposal
- Emits virtually no UV rays or IR
- Ideal light emitting, building comfortable living, and working environment
- 5-year limited warranty

Low cost to retrofit

- Much labor cost is saved, because of easy replacement. Even one with little electrical experience, can achieve retrofit quickly and easily

Energy savings

- 50% energy savings vs F54 HOT5 / F28 HE T5

Material

- Full PC shell with Aluminum heat sink

Electrical and Technical Data (subject to change without notice)

Ordering Code	Bare Lamp Watt (W) *	Initial Lumen **	Base	CRI	Color Temp.	Rated Average life	MOL (in.)	Beam Angle
L46T5HO-8YY-24P-P4/P6-EB	24	3500	G5	82	3000K/3500K/4000K/5000K	50,000	46	160
L46T5HE-8YY-15P-P4/P6-EB	15	2100	G5	82	3000K/3500K/4000K/5000K	50,000	46	160

* 24W tube is to replace Fluorescent T5 HO 54W; 15W tube is to replace Fluorescent T5 HE 28W

** Initial lumen is @ 4000K

Suitable for use in fixtures where ambient temperature is between -4°F (-20°C) and 113°F (45°C).

FCC Note: This device complies with Part 18 of the FCC Rules.

Installation Guide

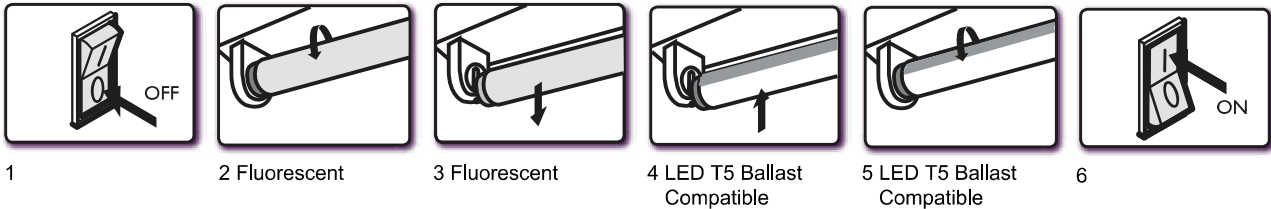

Instruction

1. Switch-off power to the luminaire
2. Remove diffuser (if provided)
3. Remove the existing fluorescent lamps from the luminaire.
- Note: Verify the fluorescent tube type is HO/HE fluorescent T5
- 4-5. Install the LED T5 Ballst Compatible lamp (One for each fluorescent lamp removed, ensure pins are firmly seated in lampholders).
Replace diffuser (if removed in step 2).
6. Switch on power to the luminaire.

CAUTION – IF THE LAMP OR LUMINAIRE EXHIBITS UNDESIRABLE OPERATION (BUZZING, FLICKERING, ETC.), IMMEDIATELY TURN OFF POWER, REMOVE LAMP FROM LUMINAIRE AND CONTACT THE MANUFACTURER

CAUTION – RISK OF FIRE. DO NOT INSTALL IN A PRE-HEAT LUMINAIRE

WARNING: RISK OF FIRE, USE ONLY IN PLACE OF FLUORESCENT LAMPS SPECIFIED ON LABEL. SEE INSTRUCTIONS.

THIS LAMP ONLY OPERATES ON ELECTRONIC BALLASTS. IF LAMP DOES NOT LIGHT WHEN THE LUMINAIRE IS ENERGIZED, REMOVE LAMP FROM LUMINAIRE AND CONTACT LAMP MANUFACTURER OR QUALIFIED ELECTRICIAN

THIS PRODUCT MAY CAUSE INTERFERENCE TO RADIO EQUIPMENT AND SHOULD NOT BE INSTALLED NEAR MARITIME SAFETY COMMUNICATIONS EQUIPMENT OR OTHER CRITICAL NAVIGATION OR COMMUNICATION EQUIPMENT OPERATING BETWEEN 0.45 – 30MHZ.